

OIL RESISTANT



Designed for applications such as those in the machine tool and manufacturing industries, the CLT Series has attained IP66G and IP67G ratings, which offer protection from oil penetration.

Offering complete protection inside, as well as enhanced endurance outside, by using long-lasting materials such as an aluminum body, tempered glass cover and fluoride-based rubber packing.

new

Oil resistant Flood-type
LED Light Bar **CLT**



Protection
Rating

IP66G
IP67G



■ IP6X = Total protection against dust (no penetration)
■ IPX7 = Protection against occasional immersion

■ IPX6 = Protection against heavy seas. A strong jet of water may not harm the appliance.
■ IPXXG = Protection against oil droplets from any direction

OIL RESISTANT CAPABILITY

(IP66G/IP67G)



- **IP6X** : Tested with negative pressure in a dust chamber for 8 hours.
- **IPX6** : Tested with a strong jet of water at 100 liters per minute from a 12.5mm diameter nozzle at 2.5-3 meter distance from the front direction.
- **IPX7** : Tested during total immersion in water at a depth of 1 meter for 30 minutes.
- **IPXXG** : Tested using water-insoluble N3 class no. 8 fluid, specified in JIS K2241, dropped from above at a rate of 0.5 liter per hour for 48 hours.

Designed with oil, dust and water-proof structure passing the tests shown above for oils in compliance with JIS K2241.

Daylight color

As bright as 500lx (at 500mm) for 6500K daylight color



Effectively designed for heat radiation

Flat front configuration possible since the back side was effectively designed for heat radiation.



Back side (CLT30-24T)

- No flicker, no stroboscopic effects, and no high-frequency inverter contributions to cause mis-reading of moving objects or eye fatigue!
- Maintain stable performance in harsh environments from a low temperature of -30°C to a high temperature of +60°C
- Available for semiconductor manufacturing machines and clean room use. Produces no infrared radiation (causing heat), and no ultraviolet radiation (causing material degradation).
- CE marking compliance. Product based on the unified EN standard in EU nations.



Three options available for your applications

CLT30-24S Side exit cable

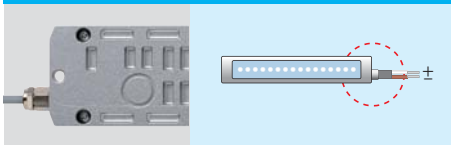

CLT30-24L Link Capability, Rear exit cables

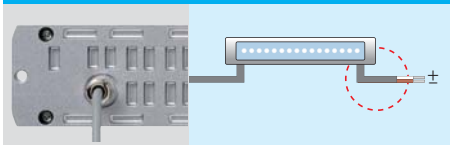

CLT30-24T Easy to connect, Rear exit terminals

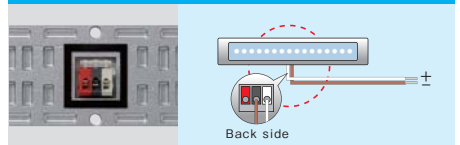

Model	LED Color	Rated Voltage	Operating Voltage Range	Current Consumption	Power Consumption	LED Source	Luminous Intensity, 50cm From Optical Center	Material	Operating Temperature	Mounting Direction	Protection Rating	Vibration resistance	Mass
CLT30-24S	-CD: Daylight	DC 24V	Rated Voltage +/- 10%	416mA ±40mA	10W	16 high-intensity LEDs	500 lx or more	Housing : aluminum Cover : tempered glass	-30°C~+60°C (RH: 90% or less, no condensation)	Any direction (for indoor use only)	IP66G/IP67G JIS C0920:2003 Aqueous oil resistant (internal regulations)	19.6m/s ²	625g
CLT30-24L													640g
CLT30-24T													610g

Dimensions (mm)

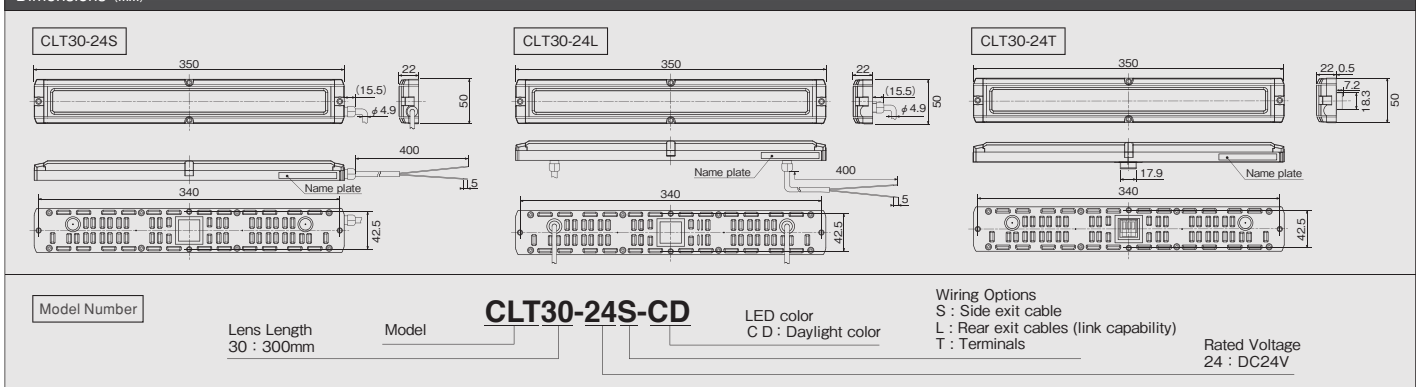

PATLITE Corporation

8-8, Matsuyamachi, Chuo-ku, Osaka, Japan 542-0067 TEL.+81-6-6763-8220 FAX.+81-6-6763-8221
International Division, Sales and Marketing Department

PATLITE (U.S.A.) Corporation
20130 S. Western Ave., Torrance, CA 90501, U.S.A. TEL.+1-310-328-3222 FAX.+1-310-328-2676

PATLITE Europe GmbH
Am Soeldnermoos 8, D-85399 Hallbergmoos, Germany

PATLITE (SINGAPORE) PTE LTD
No.2 Leng Kee Road, #05-01 Thye Hong Centre, Singapore 159086 TEL.+65-6226-1111 FAX.+65-6324-1411

PATLITE (CHINA) Corporation
Room 512, Jufeng Business Building, No.697-3 Lingshi Road, Shanghai China 200072 TEL.+86-21-6630-8969 FAX.+86-21-6630-8938

<http://www.patlite.com>

E-mail: overseas@patlite.co.jp

CAUTION

To ensure correct use of these products, read the "Instruction Manual" prior to use.
Failure to follow all safeguards can result in fire, electric shock, or other accidents.
Specifications are subject to change without notice.



PATLITE ECO PROJECT

For the benefit of mankind and the earth, Patlite is committed to developing environmentally friendly products.